

NOTE:
 1. SEE DWG. E-3 FOR GENERAL NOTES.
 2. FOR THE BREAKER POWER PLAN, SEE DWG. E-12.

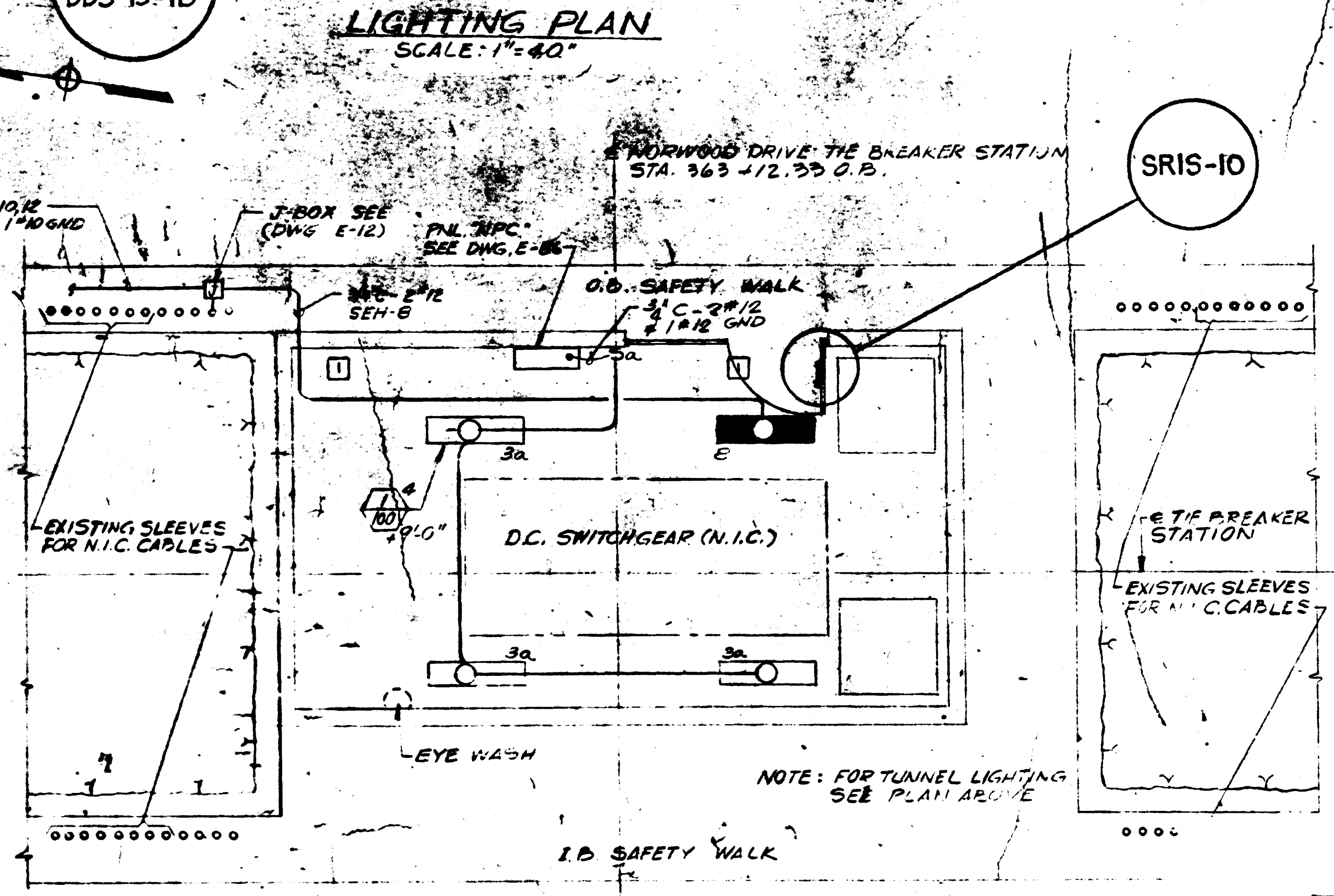

AS-BUILT
 Contract No 1Z009C
 April 22-1983
 I certify that this drawing accurately depicts the work as constructed.
 President
JACK STONE SIGN INC.

FOR INFORMATION ONLY
 USE THIS DRAWING TO LOCATE TUNNEL GRAPHICS PER CONTRACT 1Z009C ONLY

DESIGNED	M. FEUERSTEN	2-9-73
DRAWN	F. MAR	2-21-73
CHECKED	L. ABRAHAM	10-13-78
APPROVED	<i>[Signature]</i>	DATE

REFERENCE DRAWINGS	
NUMBER	DESCRIPTION
A-3	NORWOOD DR. PAN SHAFT & BRADLEY LANE TIE BREAKER STATION - PLANS AND SECTIONS
M-17	OLIVER ST TRACTION POWER SUBSTATION BRADLEY LANE TIE BREAKER STATION - PLAN AND
E-4	TUNNEL LIGHTING PLAN & DETAILS
E-13	TUNNEL POWER PLANS

REVISIONS		
DATE	BY	DESCRIPTION
5-18-81	<i>[Signature]</i>	1 GENERAL REVISION PER PCO # 1

WASHINGTON METROPOLITAN AREA TRANSIT AUTHORITY		ROCKVILLE ROUTE	
PARSONS ASSOCIATES THE RALPH M. PARSONS COMPANY SECTION DESIGNER		DE LEUW, CATHAR & COMPANY GENERAL ENGINEERING CONSULTANT HARRY WESE & ASSOCIATES GENERAL ARCHITECTURAL CONSULTANT	
SUBMITTED BY: <i>[Signature]</i>		APPROVED: <i>[Signature]</i>	
TUNNEL LIGHTING PLANS AND DETAIL STA. 345+00 TO STA. 357+00		DRAWING NO. FAIO-E-5	
SCALE: 1" = 10'-0"		AND AS NOTED	
		M523-23	



NORWOOD DRIVE FAN SHAFT
STA 363+15 (O.B.)
SEE DWG. E-18 & E-19

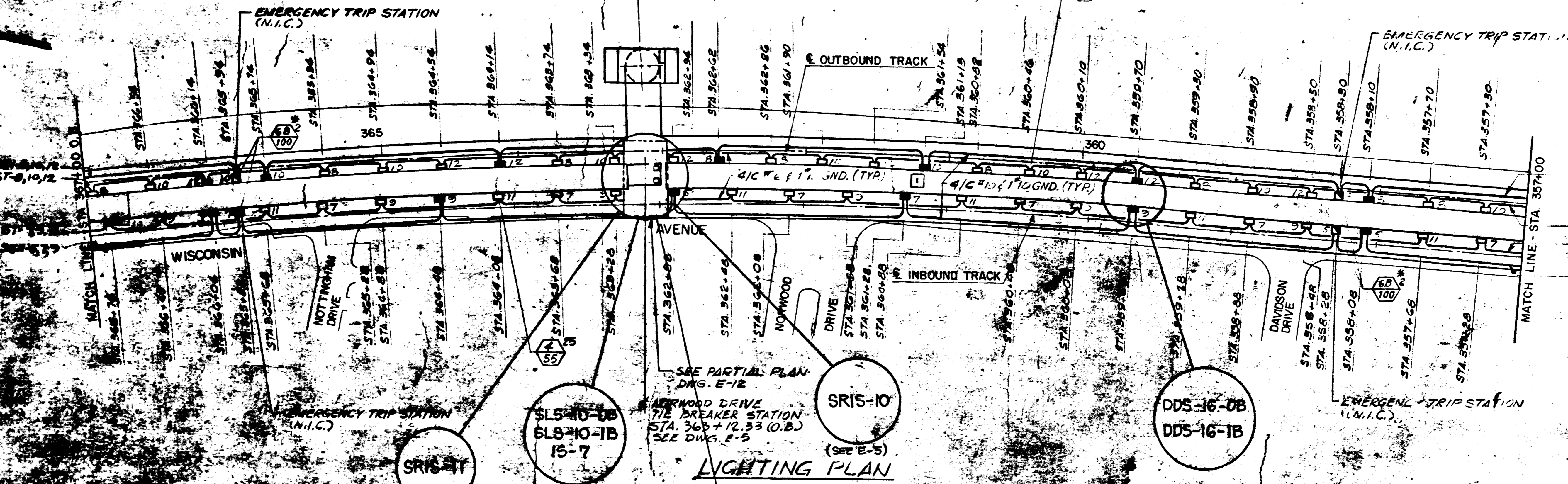

SEH-8, 10, 12
ST-8, 10, 12
ST-7, 9, 11
SEH-5, 7, 9

SEE PARTIAL PLAN
DWG. E-12
NORWOOD DRIVE
TIE BREAKER STATION
STA 363+12.33 (O.B.)
SEE DWG. E-3

LIGHTING PLAN

NOTE:
1. SEE DWG. E-3 FOR GENERAL NOTES.

AS BUILT
Project No. 12009C
April 22, 1983
Verify that this drawing
accurately depicts the work
as constructed.
JACK STONE SIGNING

FOR INFORMATION ONLY
USE THIS DRAWING TO LOCATE TUNNEL
GRAPHICS PER CONTRACT 12009C ONLY

E-19	NORWOOD DR. FAN SHAFT LIG. PLANS & SECTIONS
E-18	NORWOOD DR. FAN SHAFT PWR PLANS & ONE-LINE DIAG.
REFERENCE DRAWINGS	
NUMBER	DESCRIPTION
S-2	NORWOOD DR. FAN SHAFT PLANS AND SECTIONS
A-3	NORWOOD DR. FAN SHAFT & BRADLEY LANE TIEBREAKER STATION - PLANS AND SECTIONS
M-13	NORWOOD DR. FAN SHAFT PLANS AND SECTIONS
E-5	TUNNEL LIGHTING PLANS & DETAILS
E-12	TUNNEL POWER PLAN

REVISIONS	
NUMBER	DESCRIPTION
1	GENERAL REVISION PER PCO # 1

WASHINGTON METROPOLITAN AREA TRANSIT AUTHORITY

PARSONS ASSOCIATES & THE RALPH M. PARSONS COMPANY SECTION DESIGNER SUBMITTED BY: <i>[Signature]</i>	DE LEUW, CATHAR & COMPANY GENERAL ENGINEERING CONSULTANT HARRY WEESE & ASSOCIATES GENERAL ARCHITECTURAL CONSULTANT APPROVED: <i>[Signature]</i>
---	---

ROCKVILLE ROUTE
TUNNEL LIGHTING PLAN & DETAILS
STA 357+00 TO STA 367+00

SCALE: 1" = 40' AND AS NOTED

DRAWING NO. **FA10-E-4** M523-24

DESIGNED: M. FIDELSTEIN 2-2-72
DRAWN: F. BAR 2-10-72
CHECKED: L. ABRAHAM 10-10-75
APPROVED: *[Signature]* 6-2-77

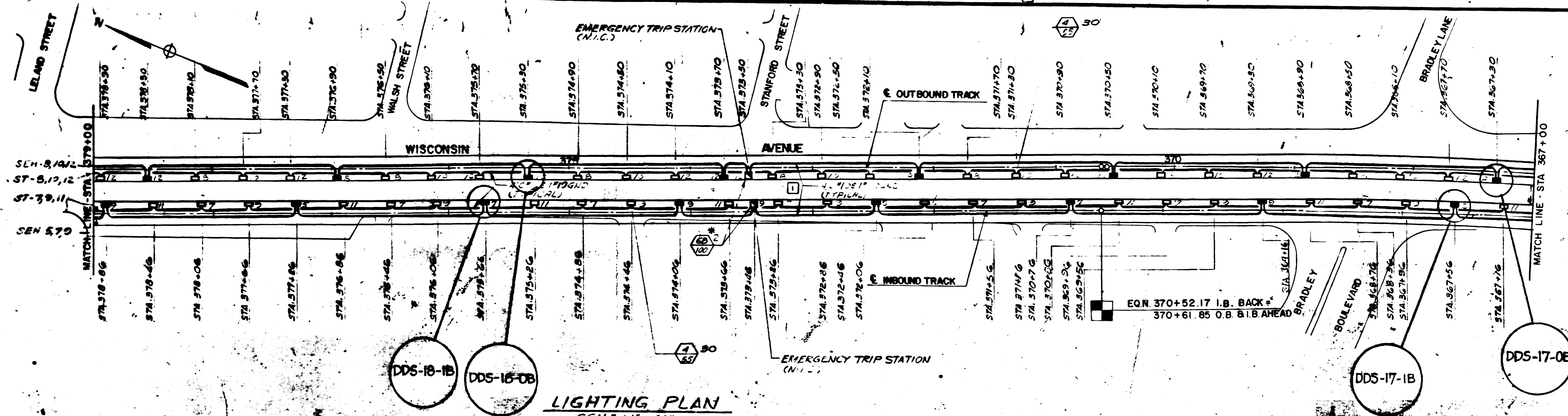

LIGHTING PLAN
SCALE: 1" = 40"

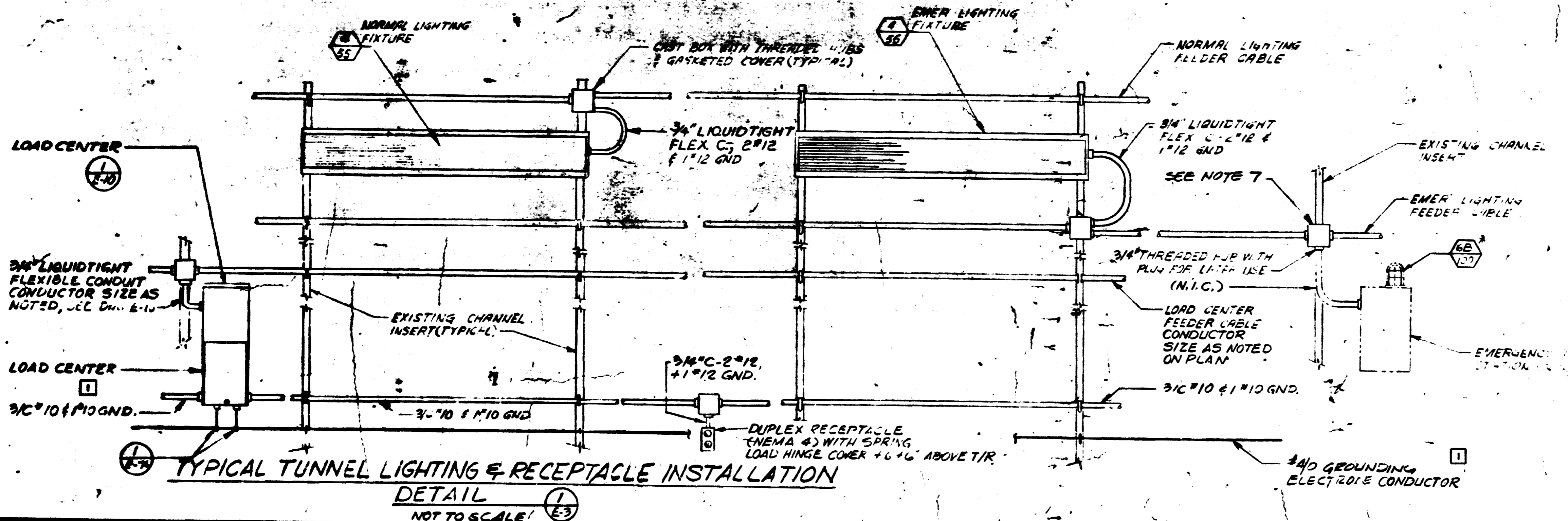
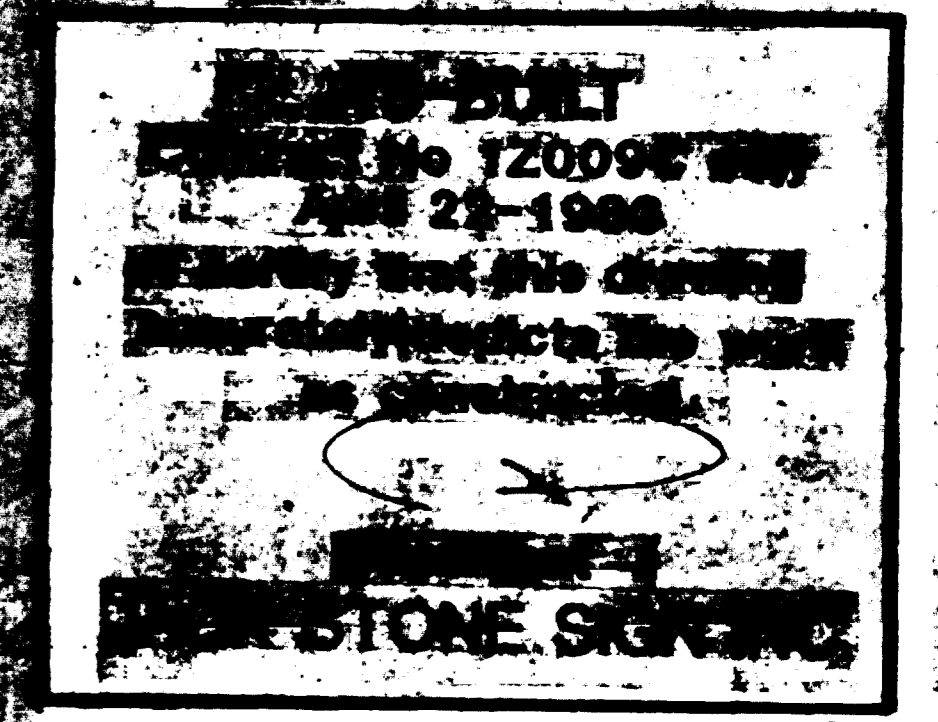

- GENERAL NOTES: (FOR E-2 THRU E-9)**
- SEE DWG. E-1 FOR SYMBOLS, ABBREVIATIONS AND GENERAL NOTES.
 - SEE DWG. E-2 FOR LIGHTING FIXTURE SCHEDULE.
 - SEE DETAIL 1 THIS SHEET FOR TYPICAL TUNNEL LIGHTING FIXTURE INSTALLATION.
 - SEE DWG. E-11 FOR EQUIPMENT SPACE ALLOCATION IN TUNNEL.
 - UNLESS OTHERWISE NOTED, ALL FEEDER AND BRANCH CIRCUIT WIRING IN TUNNEL AREAS SHALL BE MULTI-CONDUCTOR CABLE.
 - SEE DWG. E-10 FOR TYPICAL LOAD CENTER WIRING DIAGRAM.
 - THE JUNCTION BOX SHALL BE INSTALLED WITHIN ONE FOOT OF THE JUNCTION BOX. A THREE FOOT CABLE SHALL BE TAPPED TO THE THROUGH CIRCUIT CABLE. ENDS OF CONDUCTORS TAPPED FOR FUTURE CONNECTION BY THE CONTRACTOR.

FOR INFORMATION ONLY
USE THIS DRAWING TO LOCATE TUNNEL GRAPHICS PER CONTRACT 12009C ONLY

DESIGNED	M. FEUERSTEIN	2-9-72
DRAWN	F. MAR	2-13-73
CHECKED	L. ABRAHAM	10-16-75
APPROVED	[Signature]	DATE

REFERENCE DRAWINGS	
NUMBER	DESCRIPTION
E-11	TUNNEL POWER PLANS & DETAILS

REVISIONS		
NUMBER	DATE	DESCRIPTION
1	3-18-81	GENERAL REVISION PER PCG # 1

WASHINGTON METROPOLITAN AREA TRANSIT AUTHORITY

PARSONS ASSOCIATES
THE RALPH M. PARSONS COMPANY
SECTION DESIGNER

DE LEUW, CATHER & COMPANY
GENERAL ENGINEERING CONSULTANT

HARRY WEESE & ASSOCIATES
GENERAL ARCHITECTURAL CONSULTANT

SUBMITTED BY: [Signature]
APPROVED: [Signature]

ROCKVILLE ROUTE
TUNNEL LIGHTING PLAN AND DETAIL
STA. 367+00 TO STA. 379+00

SCALE: 1" = 40'
AND AS NOTED

DRAWING NO. FA10-E-3
M523-25

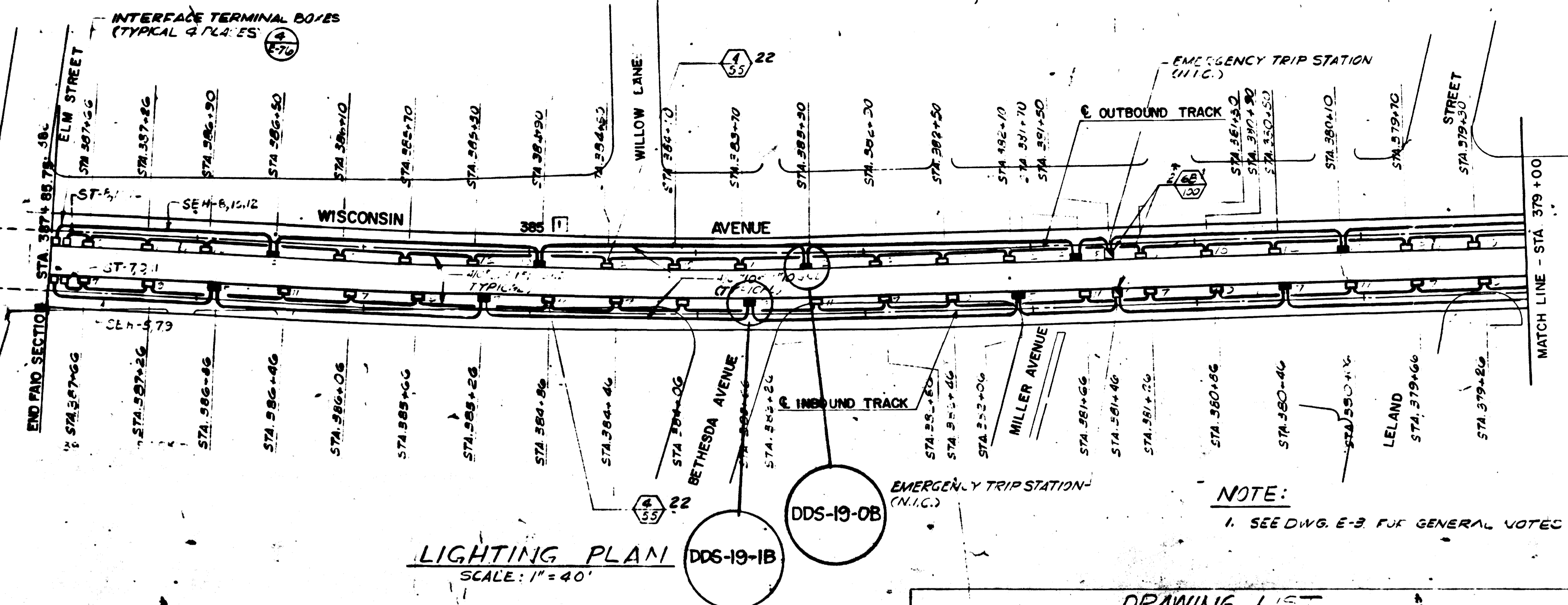
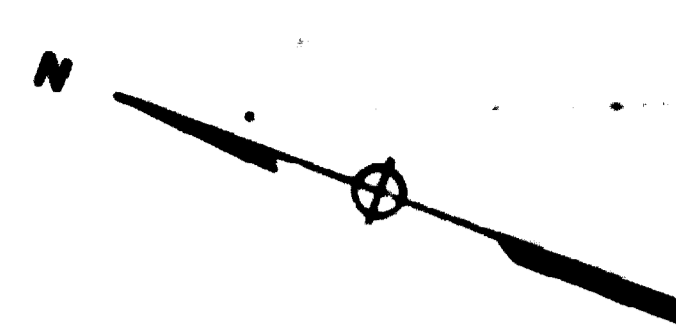

LIGHTING PLAN
SCALE: 1" = 40'

AS-BUILT
Drawing No. 12009C-111E
April 22-1988
I certify that this drawing
accurately depicts the work
as constructed.
ROCK STONE SIGNATURE

NOTE:
1. SEE DWG. E-3 FOR GENERAL NOTES

LIGHTING FIXTURE SCHEDULE

FIXTURE TYPE	REF. DWG.	FIXTURE TYPE	REF. DWG.
1/100	ST-E-16	6A/50	ST-E-17
2/100	ST-E-16	6B/50	ST-E-17
3/57	ST-E-16	6C/100	ST-E-17
4/57	ST-E-16	6D/100	ST-E-17
5/57	ST-E-17	6E/100	ST-E-17
6/100	A-18 DETAIL 4	6F/100	ST-A-13
7/100	ST-A-13	6G/100	A-26
8A/100	ST-E-17	6H/100	ST-A-13
9B/150	ST-A-41	6I/100	ST-A-14
		6J/125	E-44

* INDICATES LIGHT FIXTURE WITH BLUE GLASS GLOBE AND THE EMERGENCY TRIP STATION FURNISHED BY WIMATA AND INSTALLED BY SSI CONTRACTOR.

DRAWING LIST

NO.	AREA	DRAWING GROUP
1	TUNNEL	E-2 THRU E-17
2	CHILLED WATER PLANT	E-90 HR. E-93
3	DRUMMOND AVE. DRAINAGE PUMP STATION	E-14
4	NORWOOD DRIVE, FAN SHAFT	E-18 AND E-19
5	DRUMMOND AVE. VENT SHAFT	E-20
6	OLIVER STREET FAN SHAFT	E-22 AND E-23
7	OLIVER STREET TRACTION POWER STATION	E-24 AND E-25
8	FRIENDSHIP HEIGHTS STATION A.C. UNIT SUBSTATION AND LINE DIAGRAM	E-27 AND E-28
9	CHILLED WATER PLANT 480V SWITCHGEAR SCHEDULE	E-29
10	FRIENDSHIP HEIGHTS STATION PANEL SCHEDULES	E-30 THRU E-36 & E-33 THRU E-37
11	NORTHEAST VENT SHAFT	E-47
12	FRIENDSHIP HEIGHTS STATION	E-37 THRU E-59 & 78
13	INGOMAR STREET VENT SHAFT	E-60 AND E-61
14	SCHEMATIC DIAGRAMS	E-62 THRU E-63
15	POWER CONDUIT SCHEDULE	E-66 THRU E-69
16	COMMUNICATION CONDUIT SCHEDULE	E-71 THRU E-72 AND E-89
17	CABLE SCHEDULES	E-73 THRU E-74
18	MISCELLANEOUS DETAILS	E-75 THRU E-77
19	VENT SHAFTS & NORT.	
20	A.C. POWER GROUNDING	
21	480V SWITCHGEAR S.	
22	VICTOR CENTRAL CENTER	
23	FRIENDSHIP HEIGHTS STATION BUS, NET, CABINET DETAILS	

FOR INFORMATION ONLY
USE THIS DRAWING TO LOCATE TUNNEL GRAPHICS PER CONTRACT 12009C ONLY.

DESIGNED	M. FEUERSTEIN	2-9-73	DATE	NUMBER	DESCRIPTION	DATE	BY	DESCRIPTION
DRAWN	F. MAR	2-9-73	DATE	E-10	TUNNEL POWER PLAN & DETAILS	9-12-80		ADDED FIXTURE TYPE 'S-14' PER AM #1
CHECKED	L. ABRAHAM	10-14-75	DATE	E-76	MISCELLANEOUS DETAILS	5-18-81		GENERAL REVISION PER PCO #1
APPROVED			DATE					

WASHINGTON METROPOLITAN AREA TRANSIT AUTHORITY

PARSONS ASSOCIATES
THE RALPH M. PARSONS COMPANY
SECTION DESIGNER

DE LEUW, CATHER & COMPANY
GENERAL ENGINEERING CONSULTANT

HARRY WEESE & ASSOCIATES
GENERAL ARCHITECTURAL CONSULTANT

SUBMITTED BY: *Richard S. Miller*

APPROVED: _____

ROCKVILLE ROUTE
TUNNEL LIGHTING PLAN AND FIXTURE SCHEDULE
STA. 379+00 TO STA. 388+33

SCALE: 1" = 40'

DRAWING NO. FA10-E-2

M528-25

VENT SHAFT STA. 297+55.50

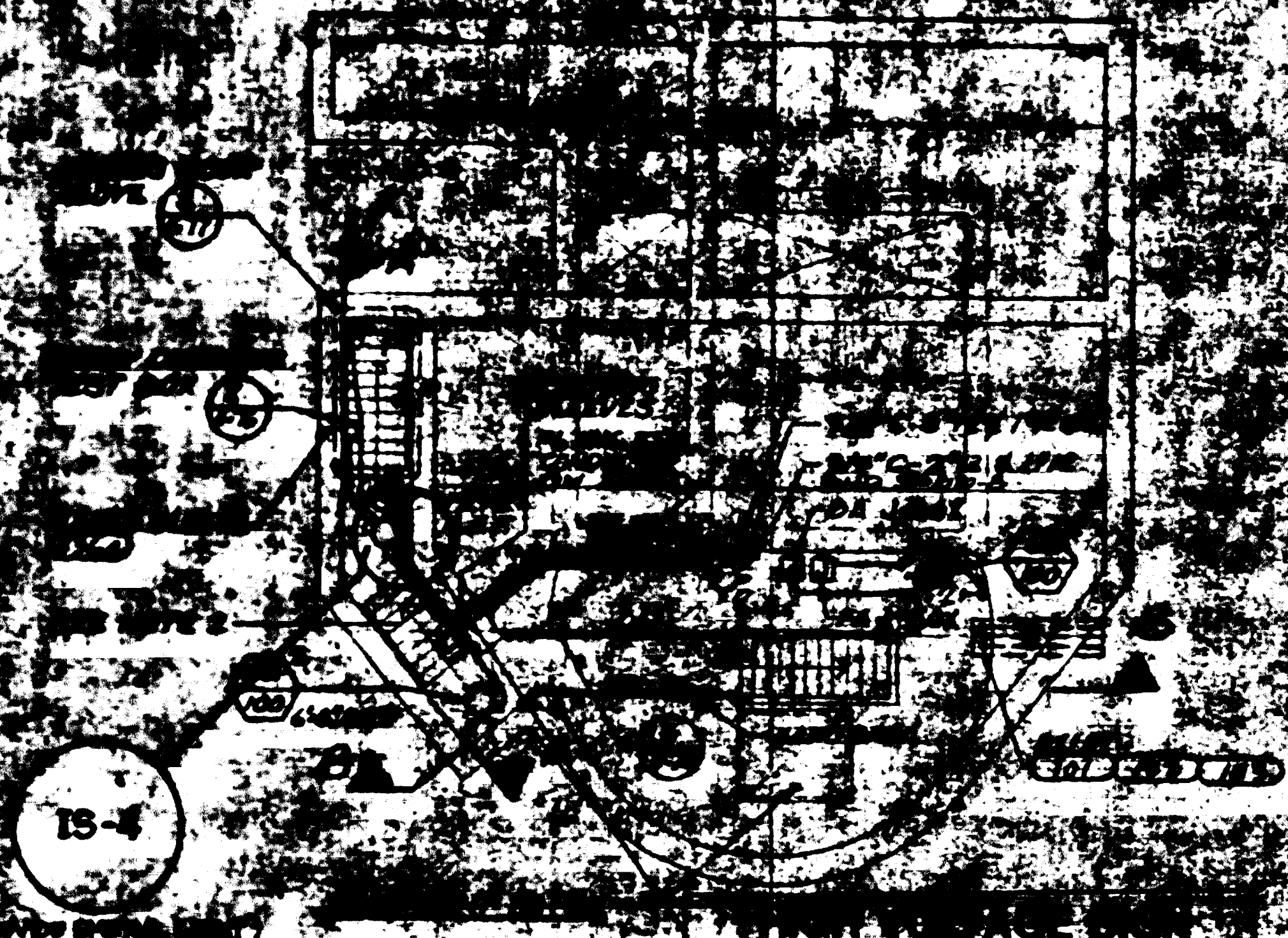

LIGHTING PLAN AT UPPER STRUCTURE
SCALE: 1/8" = 1'-0"

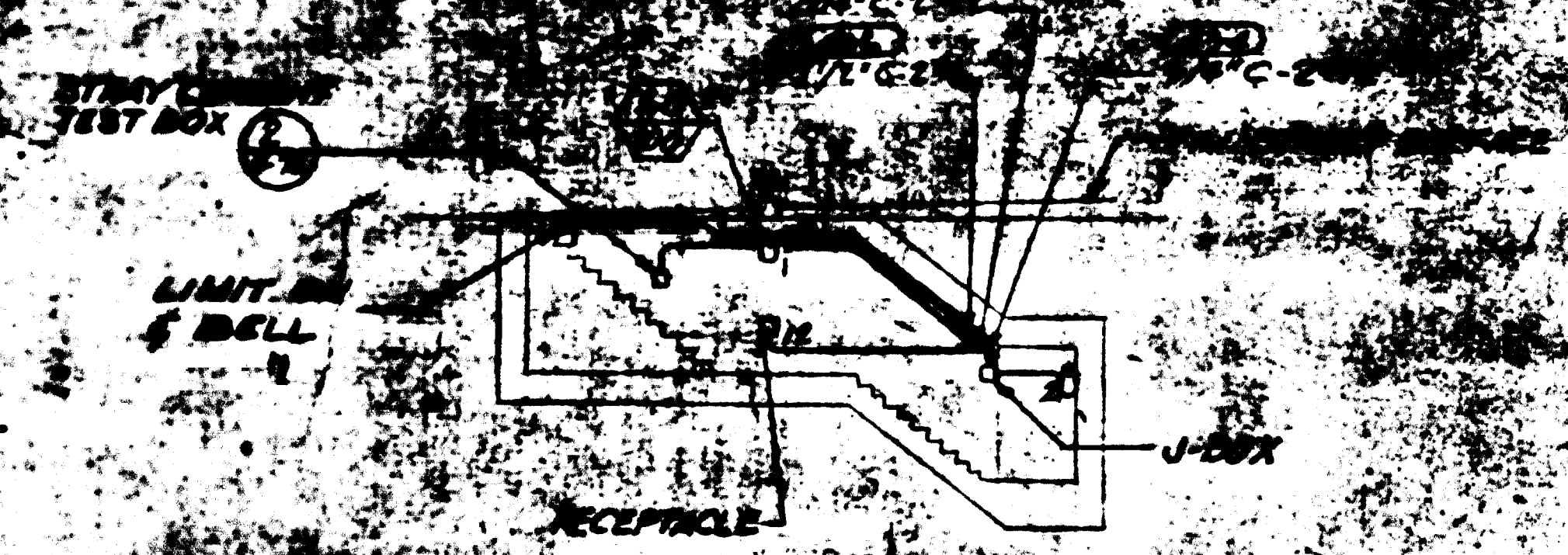

SECTION A-A
SCALE: 1/8" = 1'-0"

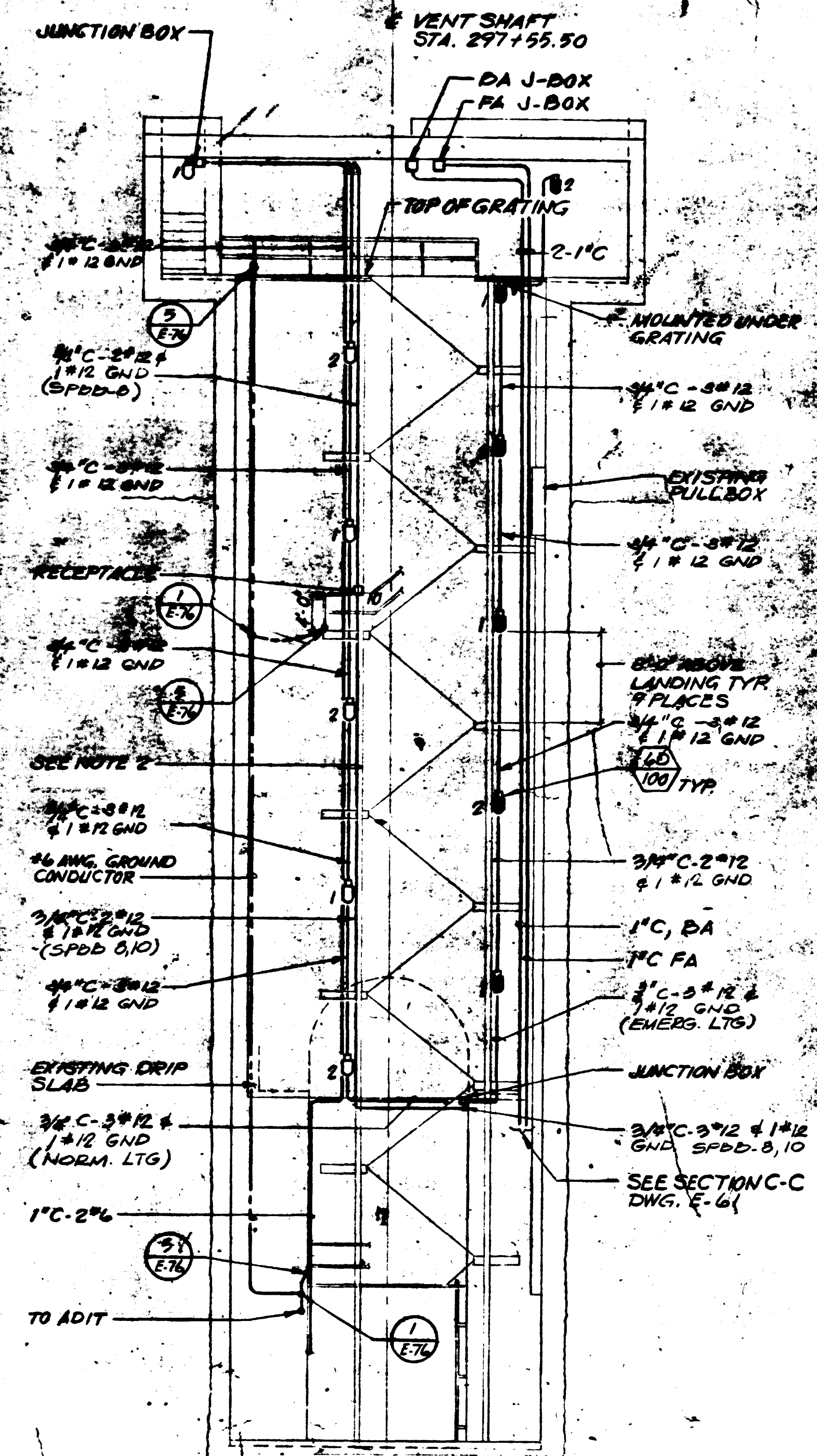

SECTION B-B
SCALE: 1/8" = 1'-0" E-61

NOTES:
1. SEE DWG. E-1 FOR SYMBOLS, ABBREVIATIONS & GENERAL NOTES.
2. INSTALL CONDUIT ON WALL.

15-BUR2
Drawing No. 12009C only
April 22-1983
Please refer to this drawing
before starting the work
as constructed.
ROCK STONE SIGN INC.

FOR INFORMATION ONLY
USE THIS DRAWING TO LOCATE TUNNEL
GRAPHICS PER CONTRACT 12009C ONLY

REFERENCE DRAWINGS		REVISIONS	
NUMBER	DESCRIPTION	DATE	BY
S-7	INGOMAR ST. VENT SHAFT PLANS AND SECTIONS	5-18-81	[Signature]
A-12	STATION & SERVICE ROOM PLANS MEZZANINE LEVEL		
A-22	INGOMAR ST VENT SHAFT PLANS AND SECTIONS		
M-37, 38	INGOMAR ST. VENT SHAFT PLANS AND SECTIONS		
E-61	INGOMAR ST. VENT SHAFT LTG. & PWR PLAN		
E-76, 77	MISCELLANEOUS DETAILS		



WASHINGTON METROPOLITAN AREA TRANSIT AUTHORITY

PARSONS ASSOCIATES
THE RALPH M. PARSONS COMPANY
SECTION DESIGNER
SUBMITTED BY: [Signature]

DE LEUW, CATHAR & COMPANY
GENERAL ENGINEERING CONSULTANT
HARRY WEESE & ASSOCIATES
GENERAL ARCHITECTURAL CONSULTANT
APPROVED: [Signature]

**ROCKVILLE ROUTE
INGOMAR ST. VENT SHAFT
LIGHTING, PLAN AND SECTIONS**

SCALE: 1" = 1'-0" 10 2 4 6 8 10
DRAWING NO. FA10-E-60
M522-27

SRIS-6

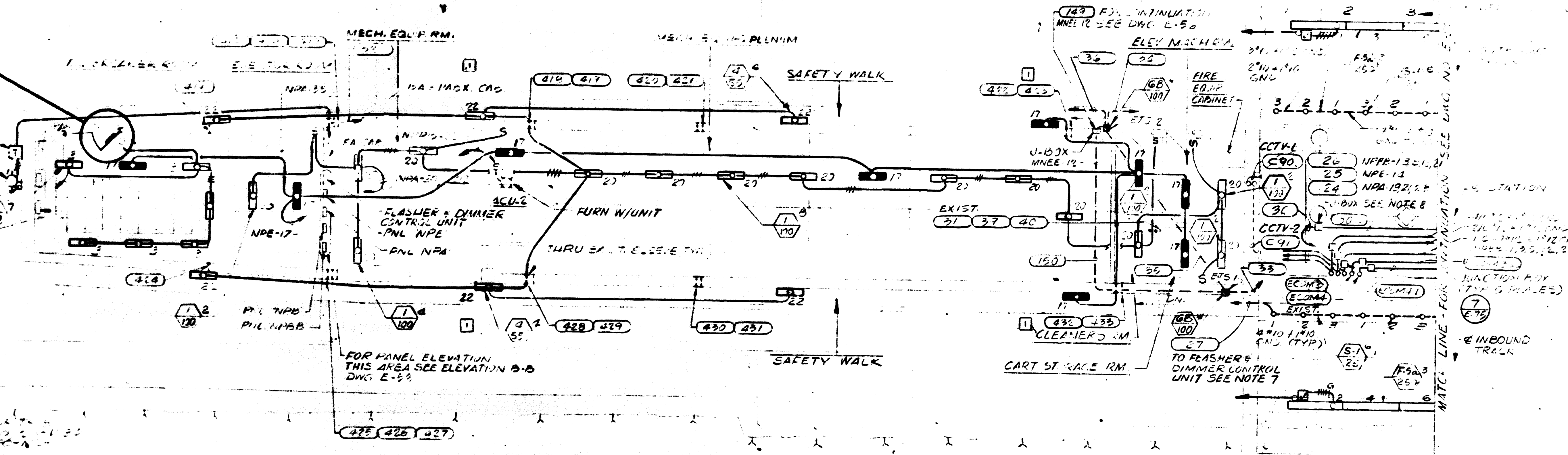

LIGHTING PLAN
SCALE 1/8" = 1'-0" E-39, 50

AS-BUILT
Contract No 12009C only
April 22-1983
I certify that this drawing
accurately depicts the work
as constructed.

President
JACK STONE SIGN INC.

9. THE $\frac{1}{100}$ TYPE FIXTURES LOCATIONS ARE APPROXIMATE. EXACT LOCATION SHALL BE DETERMINED AFTER THE EQUIPMENT IS INSTALLED TO CLEAR ALL MECHANICAL AND ELECTRICAL EQUIPMENTS, PROVIDE BEST ILLUMINATION POSSIBLE.
10. UNLESS OTHERWISE NOTED, A/C POWER SYSTEM EQUIPMENT AND WIRING SHALL BE INSTALLED ON EXISTING PREFORMED CHANNEL INSERTS AND CONFINED TO DESIGNATED SPACE ENVELOPE. CABLES SHALL BE SECURED BY STAMP OFF CLAMPS COMPATIBLE WITH CHANNEL INSERTS, AS SHOWN ON DETAIL I, DWG. E-11.

GENERAL NOTES:

1. SEE DWG. E-1 FOR SYMBOLS, ABBREVIATIONS & GENERAL NOTES.
2. SEE DWGS. E-46 THROUGH E-51 FOR LIGHT SCHEDULES.
3. SEE DWGS. 73 AND E-34 FOR CABLE SCHEDULES.
4. CABLE RUNS ARE SHOWN DIAGRAMMATICALLY ON PLATFORM PLANS. SEE TYPICAL SECTION OF PLATFORM DWG. E-37 FOR EXACT LOCATION OF CABLE SPACE ENVELOPE.
5. INSTALL JUNCTION BOX FOR FLYON ON UNDERSIDE OF PLATFORM IN R.A. PLENUM. SEE LINES, ST.M-85 FOR FLYON DETAILS.
6. SEE DWG. E-2 FOR LIGHTING FIXTURE SCHEDULE.
7. NUMERAL WITH PLATFORM LIGHTS INDICATES PHASE CONNECTION. S-1 INDICATES FIXTURE TYPE.
8. 10" X 10" X 6" J-BOX MOUNT TO UNDERSIDE OF PLATFORM NEAR MATCHLINE COVER FOR PERIODIC INSPECTION.

FOR INFORMATION ONLY
USE THIS DRAWING TO LOCATE TUNNEL GRAPHICS PER CONTRACT 12009C ONLY

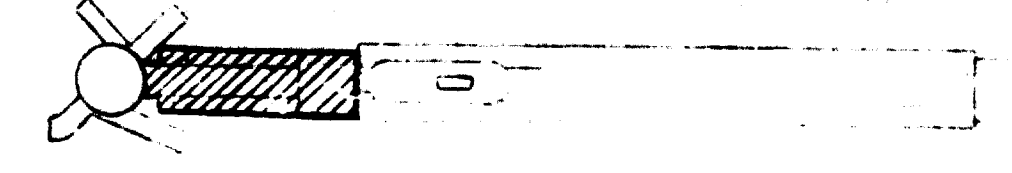

KEY PLAN

E-39 PLATF LEVEL-LTG. PLAN & SECTION		REVISIONS		WASHINGTON METROPOLITAN AREA TRANSIT AUTHORITY PARSONS ASSOCIATES & THE RALPH M. PARSONS COMPANY SECTION DESIGNER DE LEUW, CATHER & COMPANY GENERAL ENGINEERING CONSULTANT HARRY WEESSE & ASSOCIATES GENERAL ARCHITECTURAL CONSULTANT		ROCKVILLE ROUTE FRIENDSHIP HEIGHTS STATION NORTH SERVICE ROOMS-PLATFORM LEVEL-LIGHTING PLAN	
DESIGNED M. FEUERSTEIN 9-1-72	DATE	BY	DESCRIPTION				
DRAWN F. KAR 6-7-73	1		GENERAL PLAN PLATFORM LEVEL SECTIONS			GENERAL REVISION PER PCD #1	SCALE 1/8" = 1'-0" 0 2 4 6 8 10 DRAWING NO. FA10-E-37 M523-28
CHECKED ABRAHAM 10-1-73	2		SERV. RM. IN STATION ON PLATFORM LEVEL				
APPROVED [Signature] 11-1-73	3		NORTH SERV. RMS. PLATF LEVEL & PLATF PLANS				
	4		NORTH SERV. RMS. MEZZ LEVEL LIGHTING PLAN				
	5		NORTH SERV. RMS. PLATF LEVEL POWER PLAN				

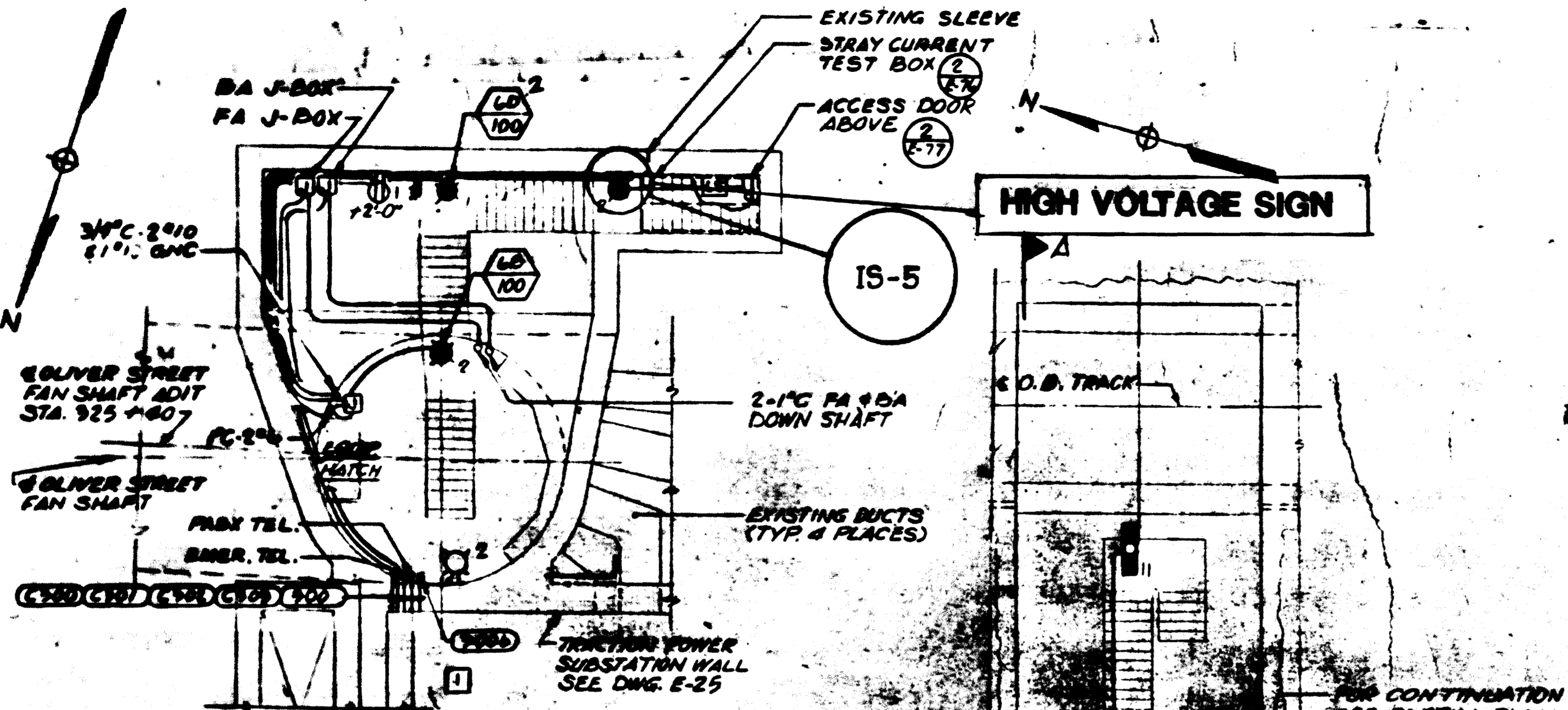

LIGHTING PLAN AT UPPER STRUCTURE
SCALE: 1/8" = 1'-0"

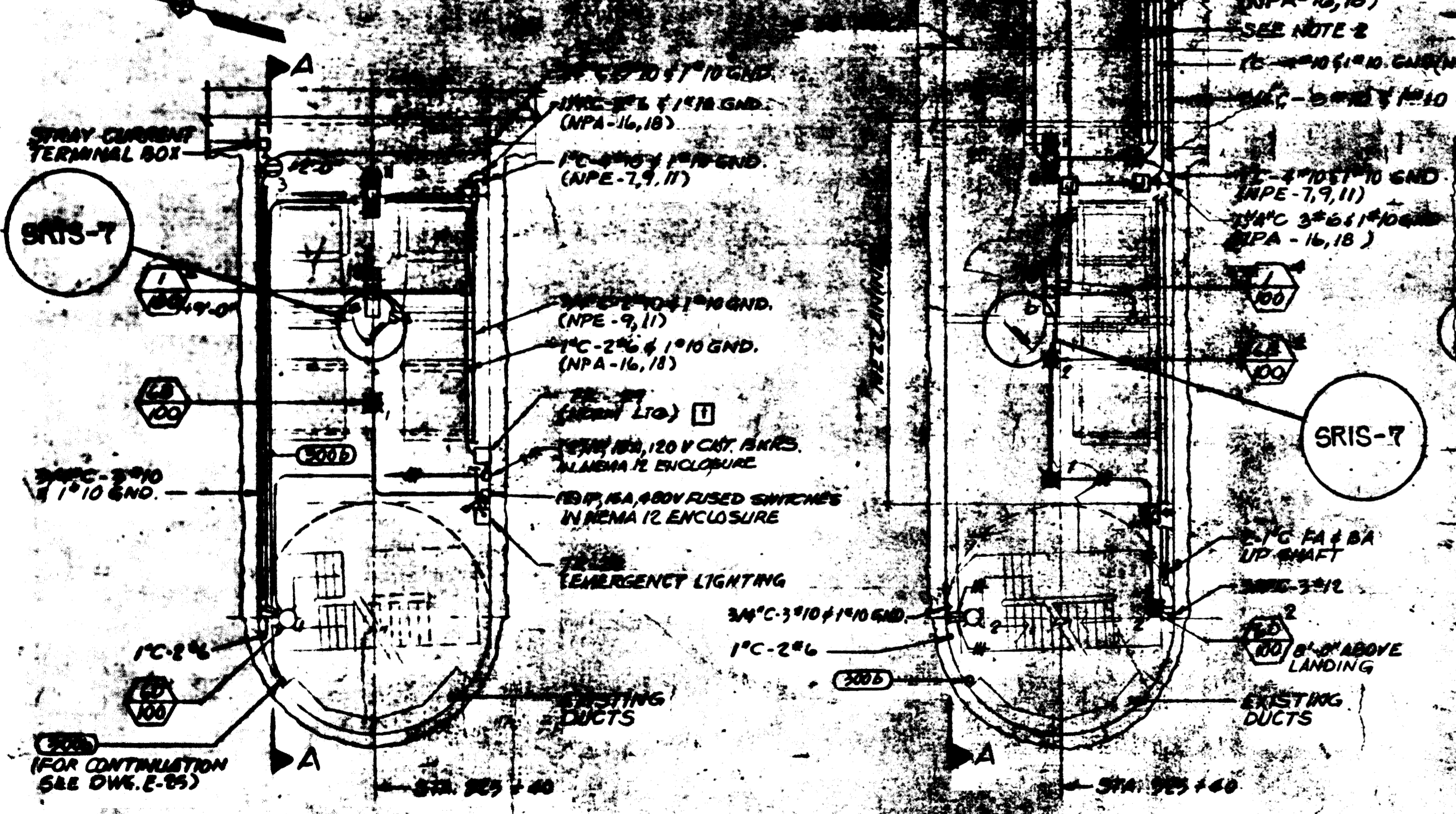

LIGHTING PLAN AT TRACK LEVEL
E-15

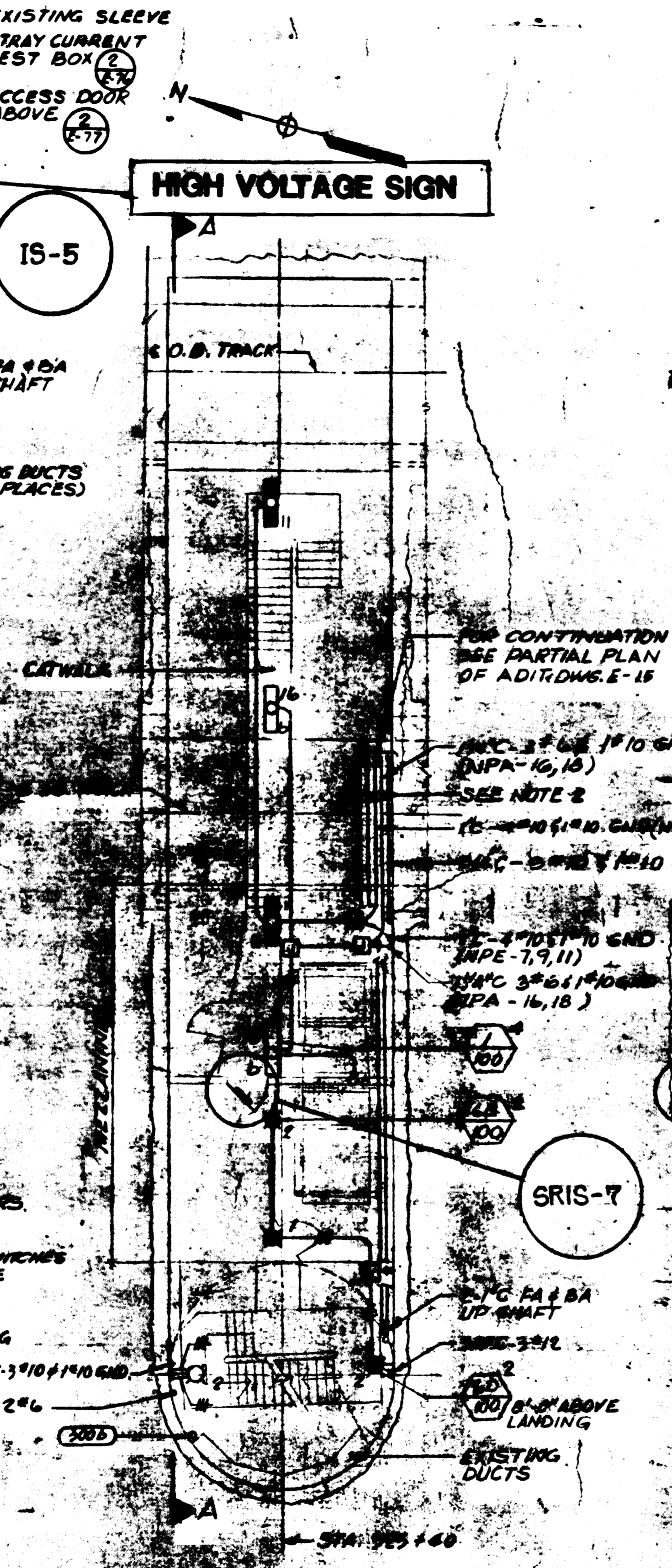

LIGHTING PLAN AT MEZZANINE LEVEL
E-15

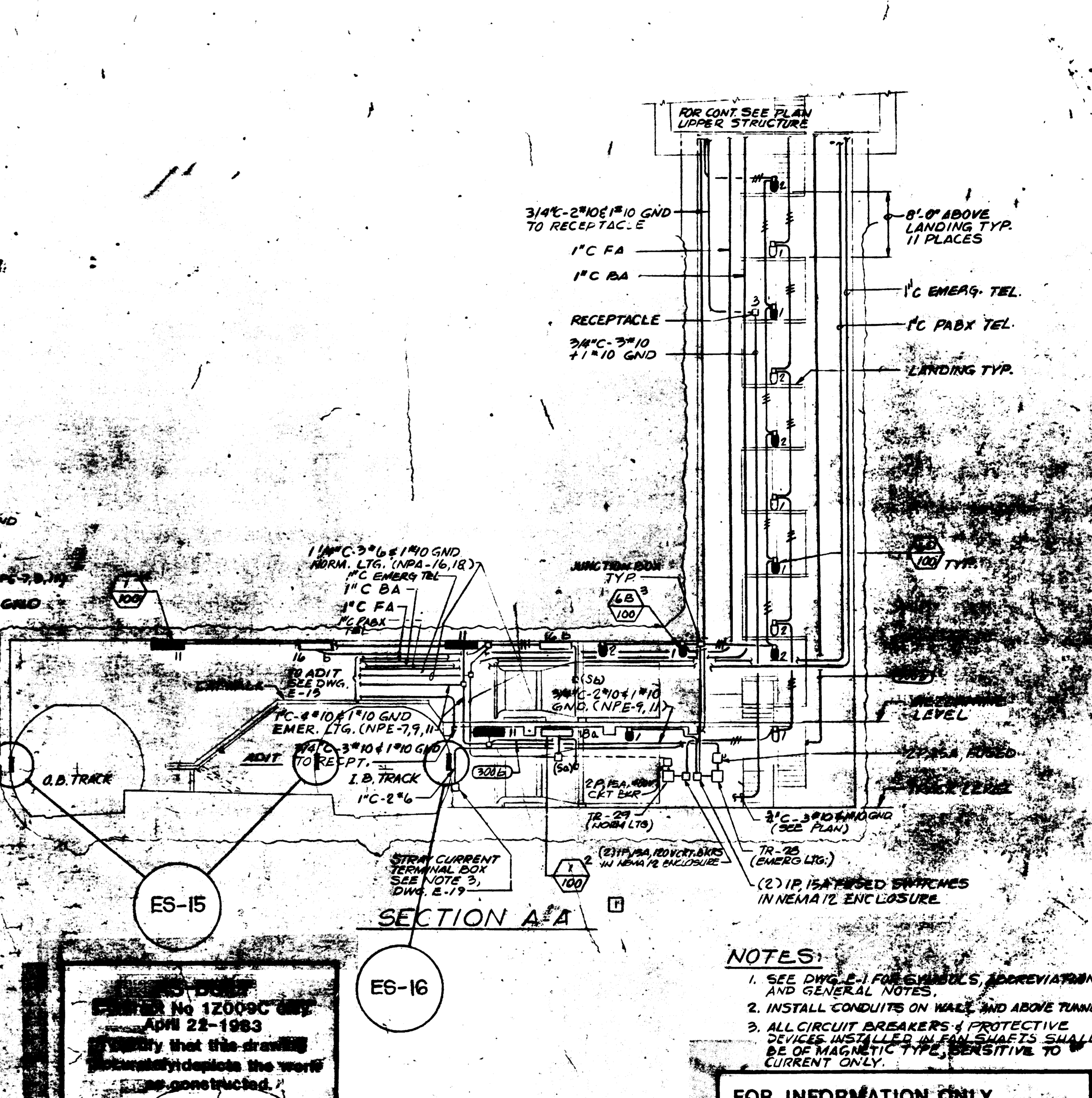

SECTION A-A

- NOTES:**
- SEE DWG. E-1 FOR SYMBOLS, ABBREVIATIONS AND GENERAL NOTES.
 - INSTALL CONDUITS ON WALL AND ABOVE TUNNEL.
 - ALL CIRCUIT BREAKERS & PROTECTIVE DEVICES INSTALLED IN FAN SHAFTS SHALL BE OF MAGNETIC TYPE, SENSITIVE TO CURRENT ONLY.

FOR INFORMATION ONLY
USE THIS DRAWING TO LOCATE TUNNEL GRAPHICS PER CONTRACT 12009C ONLY

DESIGNED BY
PROJECT No 12009C
DATE April 22-1983
Verify that this drawing accurately depicts the work to be constructed.
JACK STONE SIGNING

DESIGNED BY		REFERENCE DRAWINGS		REVISIONS	
NUMBER	DESCRIPTION	DATE	BY	DESCRIPTION	
4-10-79	M. FEUERSTEIN				
4-11-79	F. MAR	5-18-81	cl...	1 GENERAL REVISION PER PCO #1	
10-13-79	L. ABRAHAM				
E-15	TUNNEL POWER PLANS				
E-19	NORWOOD DR FAN SHAFT - LTG. PLANS & SECTIONS				
E-22	OLIVER ST FAN SHAFT - PWR PLANS, SECTIONS				

WASHINGTON METROPOLITAN AREA TRANSIT AUTHORITY

PARSONS ASSOCIATES
THE RALPH M. PARSONS COMPANY
SECTION DESIGNER

DE LEUW, CATHER & COMPANY
GENERAL ENGINEERING CONSULTANT

HARRY WEESE & ASSOCIATES
GENERAL ARCHITECTURAL CONSULTANT

APPROVED

ROCKVILLE ROUTE
OLIVER STREET FAN SHAFT
LIGHTING PLANS AND SECTIONS

SCALE: 1/8" = 1'-0" 1 2 4 6 8 10

DRAWING NO. FAIO-E-23 M523-29